



Hi-gloss cabinetry in a muted shade of grey brings a sophisticated feel to the Wilkinsons' stunning new kitchen. Thanks to its large bi-fold doors that lead onto a patio area, the open-plan room is perfect for entertaining

Deciding to improve your home can sometimes be a better option than moving and that was certainly the case for Julie Wilkinson, who works in marketing, and her husband Tim, a company director for Winebox. After considering moving to a new property that they could renovate, they realised it would be a costly venture. 'We quickly came to the conclusion that buying another house and refurbishing it would prove expensive,' recalls Julie. 'Then it dawned on us that our home already had the potential to be everything we wanted.'

The couple's current 1920s property, which they bought 11 years ago, initially had plenty of possibilities but they felt it needed lots of work to become their dream home. 'Tim spotted its potential straight away,' explains Julie. 'Although the interior needed updating, it was still liveable.'

After moving into the four-bedroom house in southwest London, the couple immediately converted the loft to create an extra bedroom and bathroom. They also extended the kitchen into their garden, adding a glass roof to flood the room with light. 'The existing layout was small and



BRING THE OUTSIDE IN

Extending into their garden allowed Julie and Tim to create their dream kitchen

My favourite... design element is the bank of appliances. Our kitchen doesn't conform to the traditional working triangle layout, so this makes full use of the space'
JULIE WILKINSON

▲ Tim's background in the wine industry meant that he wanted to include a Liebherr cooler in the new scheme. 'We treated this bank of units as a stand-alone piece of furniture,' says Julie. 'The drawers above and below the ovens really utilise every inch of storage'





A tambour unit utilises any potentially wasted space next to the fridge freezer. An electrical socket has been built in to the cabinet for the kettle, which can be hidden out of sight

Situated in the middle of the room, the island offers the couple a chance to socialise with guests while preparing food. The leather and chrome bar stools are from Barker and Stonehouse

Built in to the bank of units under the ovens is a deep warming drawer from Neff. With plenty of space for 12 place settings, three options for warming food and one for utensils, it allows Julie and Tim to entertain family and friends regularly with ease

The drawer interiors contain clever fixings from Blum's Orga-Line range. Each insert is adjustable and clicks into place to fit different sizes of crockery. 'We wanted them to look beautiful and functional,' explains Julie. 'That's why we chose them in red'

the units weren't accessible, so it was an easy decision to rip the cabinetry out,' recalls Julie.

The contemporary beech kitchen the couple installed served them well for eight years until they decided that they wanted a more practical yet still stylish home. Visiting friends who had recently updated their own property, Julie was so impressed with the results that she contacted their project manager, Martin Stribbling of Fabricari. 'Martin looked at our house and recommended designer David Hall at David Hall Bespoke Furniture to create our new kitchen,' she explains.

To house the large, open-plan layout that the couple wanted, two archways were demolished, merging the existing dining and living rooms into one space. The back of the kitchen was also further extended into the garden and full-width folding doors were installed to link it with the outside area. It was essential for Julie and Tim that their new kitchen was accessible and easy to use. They also wanted to make sure there was a place for everything and an area that they could relax in and entertain guests. 'We wanted something clean and streamlined but also beautiful, as well as being ultimately functional,' says Julie. 'Martin and David had a lot of great suggestions and we had ideas of our own, so we were very involved.'

David came up with a scheme of grey furniture with an ultra hi-gloss finish to reflect the vibrant greens from what remains of the couple's garden. He also suggested positioning the island so that it could be accessed from either side. 'This is particularly useful in the summer when we throw open the doors as we have a seating area on the patio,' explains Julie.

The couple are delighted with their new kitchen and visitors are surprised by its ultra-modern feel. 'The exterior is so traditional that they always stop in their tracks,' smiles Julie. 'I'm so happy in the kitchen now and consider this my leisure space after a hard day at work.'



The cool Zinc Grey concrete worktops are complemented beautifully by the spacious wet area. Julie and Tim love the Franke Little Butler 2000 tap that provides hot and filtered water at the turn of a lever



I get the most use... out of the island. I spend a lot of my time standing by it either looking out onto the garden or into the dining area. I love the way it lets me stay central to the action when I'm entertaining!



In addition to ample storage for Tim's large collection of wine, the couple were keen to include a seating area where they could enjoy formal meals with guests. The walnut Channel dining table and chairs are from Tablemakers and add extra warmth to the scheme, while the walls are painted in Dulux's cool Off White

◀ Sheets of acrylic have been mounted alongside fluorescent tubes within a border of gloss grey to form two illuminated trellis-style wine racks on one wall of the couple's kitchen

DESIGN & CABINETRY

- David Hall at **David Hall Bespoke Furniture**, 7 Highams Lodge Business Centre, Blackhorse Lane, London E17 6SH (020 8531 0006) www.davidhallfurniture.co.uk
- Grey hi-gloss cabinetry with an ultra-glossy Piano finish

WORKTOPS

- Zinc Grey concrete, Mass Concrete Surfaces. Price per sq m, from **£450**

SINKS & TAPS

- KBX11045 Kubus undermounted single-bowl sink in stainless steel, Franke **£282**
- KBX11020 Kubus undermounted half-bowl sink in stainless steel, Franke **£240**
- Semi-Pro Side Spray single-lever monobloc mixer tap in Silk Steel with separate rinse, Franke **£543**
- Little Butler 2000 hot and chilled filtered water tap in chrome, Franke **£663**

APPLIANCES (shown)

- B1664 built-in single oven, Neff **£988**
- B6774 built-in multifunction oven, Neff **£740**
- PGF95F2 five-burner gas hob, Smeg **£568**
- GCI20 ribbed griddle in cast iron, Smeg **£95**
- N7290 built-in warming drawer, Neff **£349**
- American-style fridge freezer, for similar try SBSes7353, Liebherr **£2,646**
- WTes4677 integrated Vinidor wine cooler, Liebherr **£2,297**

APPLIANCES (not shown)

- Canopy extractor hood, WS Westin **£570**
- Fully integrated double DishDrawer dishwasher, Fisher & Paykel **£800**

☎ For stockists, see page 144

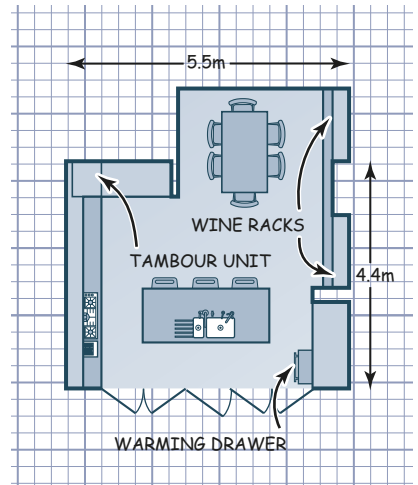

GUIDE PRICE

- Starting price for a David Hall Bespoke Furniture kitchen **£18,000**